

Installation Instructions

47233-1051

Mach 8 Series Top-Down Mounting Kit

Important! When using this method of roof top unit installation, an electric heat element must not be installed. If an electric heater is to be installed, the standard interior frame mounting method must be used to allow access to the heater from below.

When using this top-down installation method, the vehicle must be structured with a minimum 0.200" thick 6061-T6 aluminum plate embedded in the vehicle roof for the roof top unit mounting screws to engage.

1. Remove roof top unit plastic shroud.
2. See Figure 1 for locations where mounting screws will install in relation to the 14 x 14 inch opening in the vehicle roof. Even though the mounting screws are self-drilling, pilot holes may be pre-drilled in the roof at these locations.

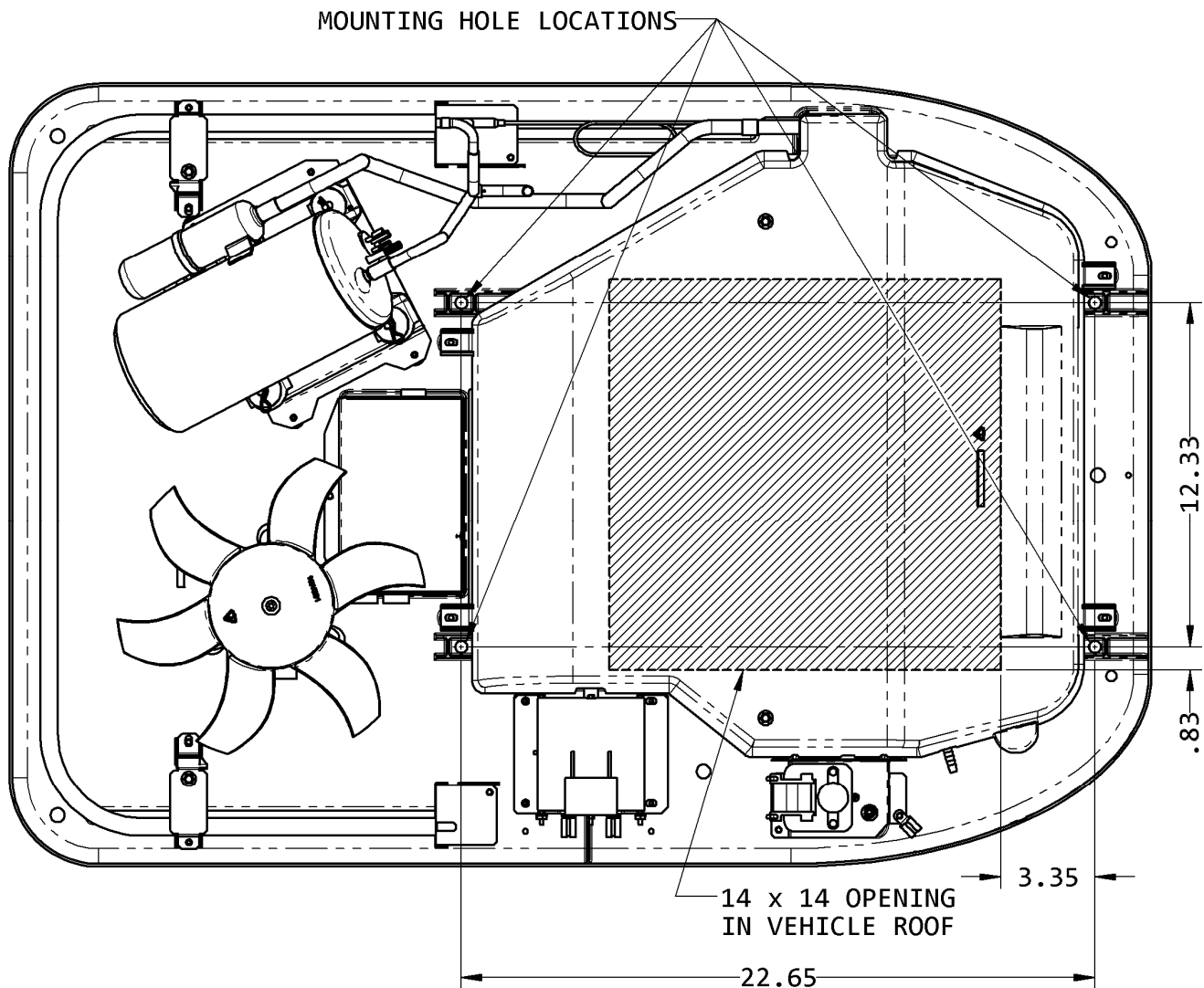

3. If needed, install foam gasket strip to bottom of unit basepan or to top of roof structure (as shown in Figure 2) to separate supply and return air ductwork.
4. Inert a nylon sleeve into each of the mounting gaskets and apply them to the bottom of the base pan aligned with each of the four mounting hole locations shown in Figure 1.
5. Apply silicone to the bottom of the roof top unit 14 x 14 gasket and align over the opening in the vehicle roof for installation.
6. Fill mounting sleeves and pockets in unit base pan around the mounting hole locations with silicone.
7. Using the 4 provided self-drilling screws, gasketed washers and mounting channels, run the screws down through the sleeves and into the vehicle roof. Tighten screws just until the sleeves pull down to the roof. Use care to NOT STRIP THE SCREWS. See Figure 2.
8. Apply silicone to the top of each mounting screw head and re-install the roof top unit plastic shroud.

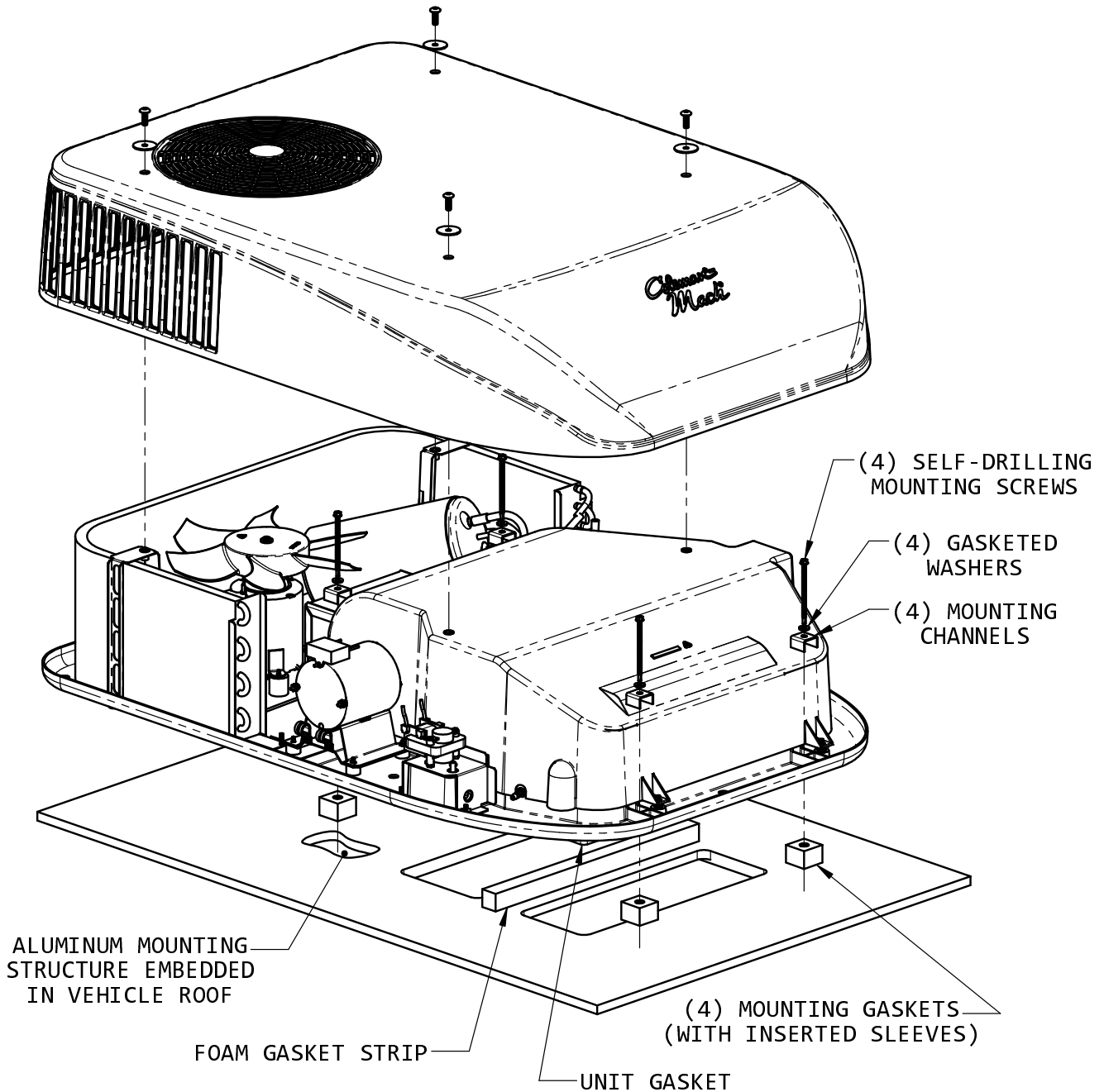

Figure 2