

# Installation Instructions

## 9430-6101

### Ceiling Assembly Upgrade Kit

#### Kit Contents

- 9470-350 - Louvers x 2
- 9430-598 – Small Parts Package
- 9430-115 - Ceiling Assembly Shroud Template x 1
- 9430-251 - Remote Control Template (for use with IRC ceiling assemblies) x 1

#### Louver Installation

1. Remove the grills and filters from the ceiling assembly shroud.
2. Remove the four Philips head screws holding the shroud in place shown in **Figure 1** and pull the shroud down from the roof of the RV.
3. Cut out the supplied ceiling shroud template and place it on the ceiling assembly shroud as shown in **Figure 2** and **Figure 3**.
4. Tape the template in place so that it cannot shift position.
5. Use a punch, or drill pilot holes in order to mark the drill locations. (Mark these locations before cutting ceiling shroud with hole saw as the template may tear during this operation).
6. Make sure the area behind the ceiling assembly shroud where the future holes will be cut is clear, or back up the ceiling assembly with a 2x4 to stop the drill as it passes through the shroud.
7. Use a 3 inch hole saw and cut out the two holes identified in the template.
8. If you have not already done so, remove the template from the shroud.
9. Install the supplied louvers by compressing the three flexible members and pushing them into their appropriate holes.
- 10. While the shroud is off the ceiling, retrofit the temperature sensor by following the steps listed in the Remount Temperature Sensor section on page X of this instruction. Once this is complete, move on to step 11 below.**
11. Reinstall shroud using the four Phillips head screws removed in step 2.
12. Replace filters and grills.



Airxcel, Inc.

RV Products Division

P.O. Box 4020

Wichita, KS 67204

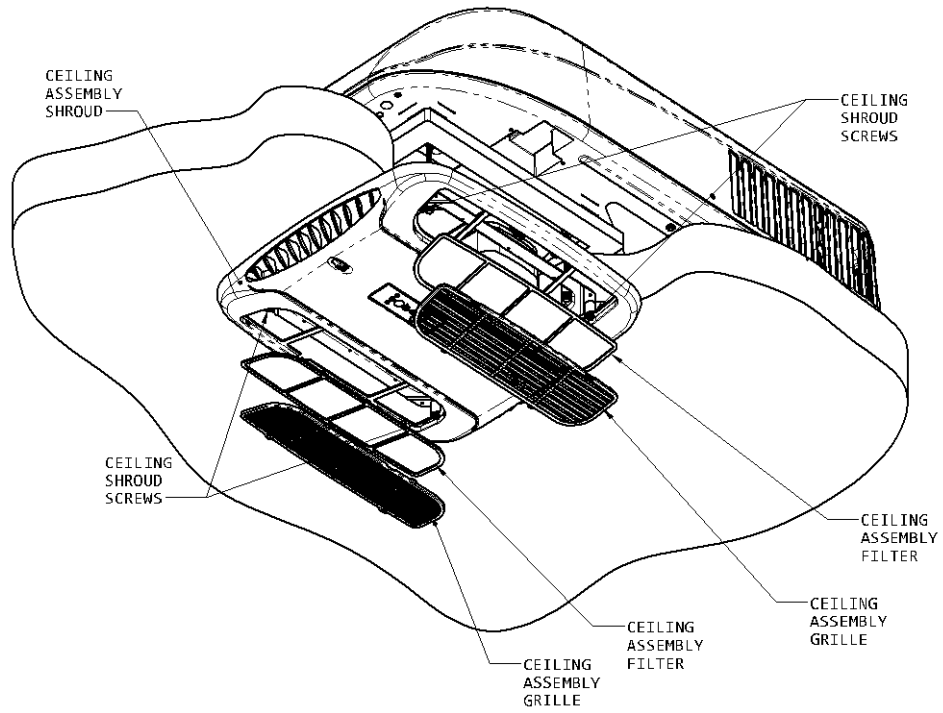

Figure 1

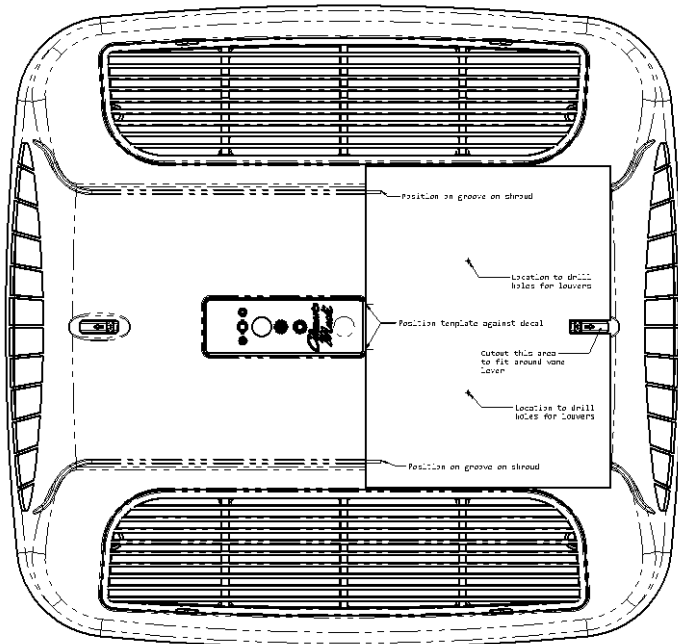

Figure 2

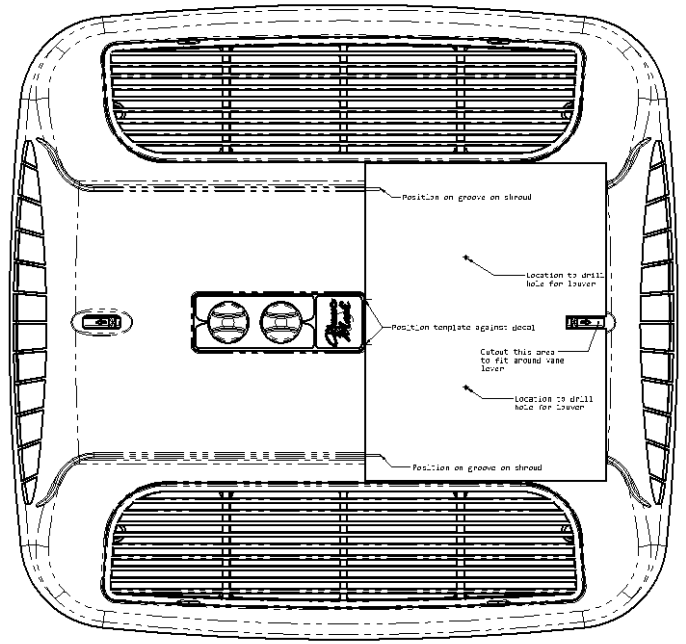
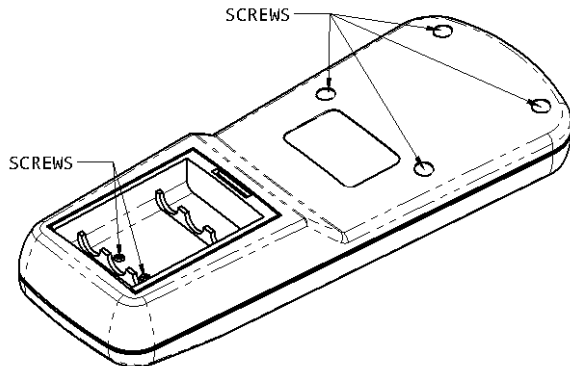

Figure 3

## Drilling IR Remote Holes

(Holes in the remote allow a more accurate temperature control in follow me mode)

1. Remove the battery cover and batteries from the IR remote.
2. Remove the 6 screws shown in **Figure 4** holding the remote halves together.
3. With the button side of the remote facing down, pull the two halves of the remote apart from each other. (Take caution when doing this as the circuit board and screen can fall out if the remote is tipped) TIP: When looking at the back of the remote, the bottom leftmost battery spring and top rightmost battery spring are attached to the circuit board and may catch on the remote cover during removal. As you separate the two halves gently press on the left spring to help it through the hole in the cover. This will keep the circuit board from being pulled away with the back half of the remote.
4. Cut out the supplied IR remote template.
5. Locate the template as shown in **Figure 5** and secure with tape to keep the template from shifting.
6. Use a punch to mark the 4 hole locations specified on the template. (If a punch is not available to mark the hole locations, be very careful drilling the holes in the next step as the template may tear)
7. Use a 3/32" drill bit to drill the four holes in the remote cover.
8. Reassemble the remote by putting the 2 remote halves back together taking care to guide the battery springs back through the openings in the remote cover seen in **Figure 6**.
9. Using the 6 screws removed in step 2, screw the 2 remote halves together.
10. Reinstall batteries and battery cover.



**Figure 4**

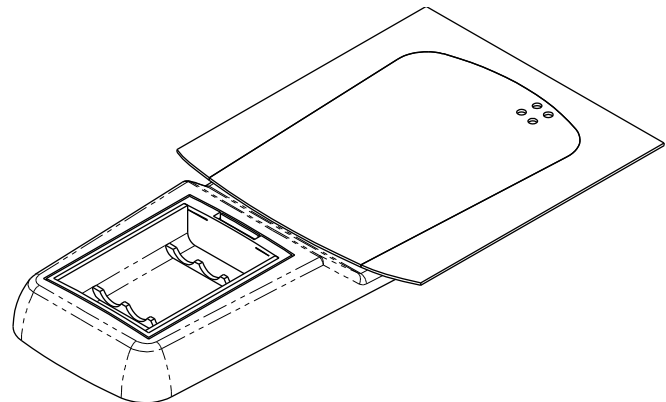

**Figure 5**



**Figure 6**

## Remount Temperature Sensor

1. Remove the screw holding the Temperature sensor to the mount frame and let the sensor hang loose.
2. Open the small parts package supplied with the kit and assemble the hardware as shown in **Figure 7** below.

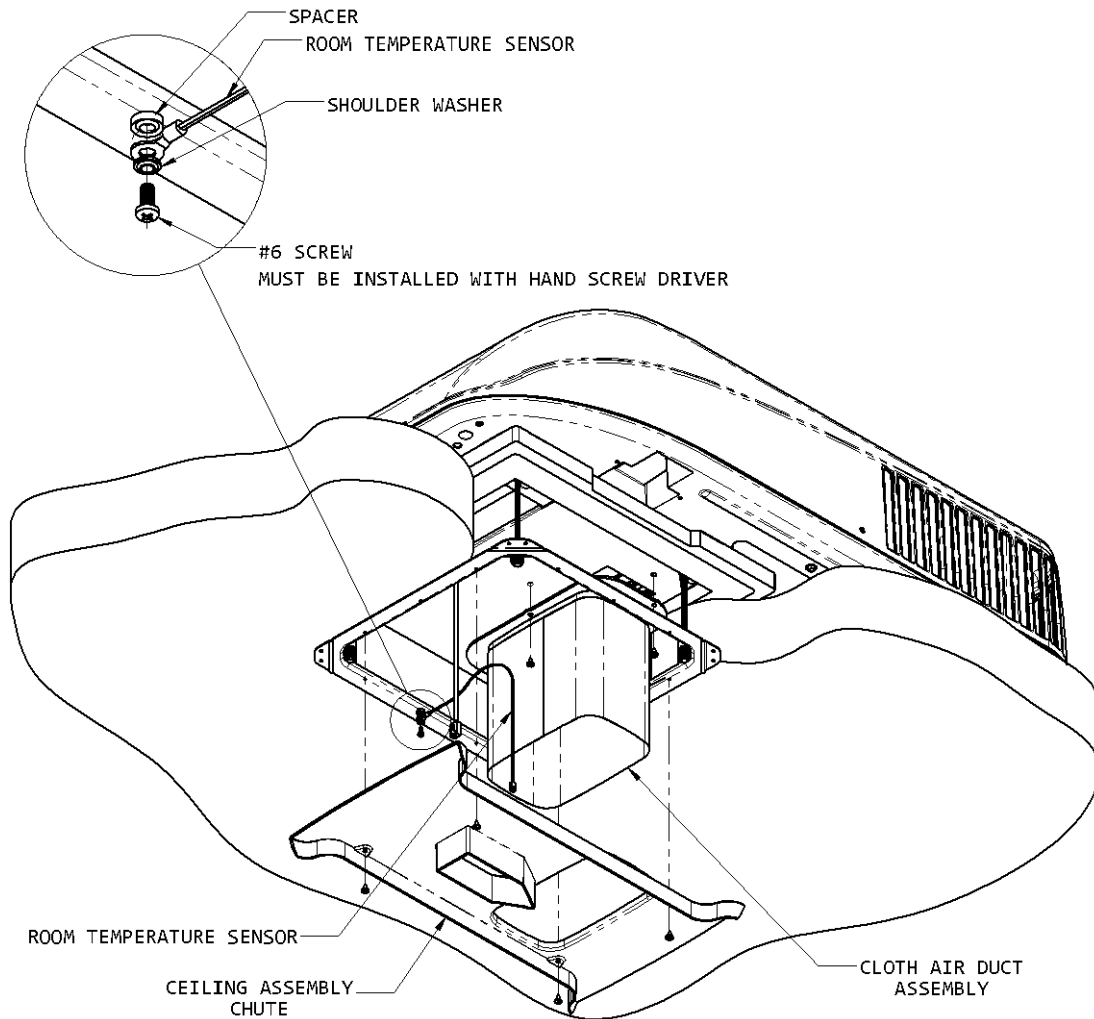

**Figure 7**