



INSTALLATION INSTRUCTIONS FOR 47233-309 MACH 8 CONDENSATE PUMP KIT

This instruction is to add a condensate pump assembly to a Mach 8 unit which was not factory equipped with a condensate pump assembly.

WARNING – ELECTRIC SHOCK HAZARD:

Insure that all roof unit electrical power has been turned OFF prior to beginning installation of this condensate pump assembly.

1. Remove upper unit polypropylene shroud. Shroud will be held with four stainless steel screws through the top. Some models may have additional smaller stainless steel screws at each side on the lower perimeter of the shroud and some models may have an additional screw at the front nose of the shroud. Retain all screws and washers for later re-assembly.
2. Remove the fan blade by turning the mount screw counterclockwise and lifting the blade off the motor shaft. This will ease access to the wirebox.
3. Remove the unit wirebox lid. It is retained by a single locknut. Use a 3/8" hex nut driver or socket to remove.
4. Remove the curbside rear wirebox strain relief bushing by squeezing the moveable section inward while exerting outward pressure.
5. If you intend to connect the condensate hose through into the unit return air section and connect to a hose routed through the roof and side wall to deposit the condensate onto the ground, you will now remove the evaporator cover which is held by four (4) locknuts; a 3/8" hex nut driver or deep well socket may be used for this. Figure 1 shows the loosened evaporator cover raised to allow access to the return air section. Cut out the aluminum tape found on the vertical wall of the return air section. With the tape removed, you will find a U-shaped depression formed in the short vertical wall. The drain insert (See Figure 1) will fit into the depression to create a continuous flat surface across the short wall. Now you may connect the large 1/2" barbed adaptor to the 1/2" dia. drain hose (provided by installer) which will drain to the ground. Reinstall the evaporator cover at this time.
6. If you intend to pump the condensate to a particular location on the roof or to engage with another user supplied hose to control the pathway to ground, you will not need to remove the evaporator cover or remove the aluminum tape.
7. At this time, remove and discard the metal bracket if supplied (some models had the bracket installed even though there was no pump assembly installed). Retain the fasteners for later use.
8. If there is no bracket (the most usual case), remove the strain relief clamp, drill a 7/32" dia. hole at the location shown in Figure 1 as 10-24 bolt. TAKE CARE that the drill does not carry through to the roof and create a hole in the roof.
9. You will now need to plug the existing holes in the drain pan which ordinarily drain onto the roof. Thoroughly clean the inside of the pan at the location of the holes to remove any oil or debris. Plug with silicon or other waterproof sealant or epoxy. Allow to cure and insure water tightness by pouring in a cup of water.
10. Install the condensate pump assembly to mount onto the basepan over the strain relief bolt. Reinstall the strain relief with umbilical wires.

11. Insert the kit provided 10-24 bolt downward through the bracket, provided green grounding wire and 7/32" basepan hole previously drilled. Engage the provided 10-24 lock nut from below the basepan. Tighten the bolt with a 5/16" hex driver. The lock nut will snug up to the pan. The added green grounding loose end will connect to the blower motor bolt using the supplied 8-32 keps nut (See Figure 1).
12. Attach the 1/4" dia. drain insert hose onto the pump standpipe. If running user supplied 1/4" inside dia. tubing, you will install it onto the pump standpipe and route to the desired location. Keep in mind that the tube cannot route higher than the unit and the end must be below the pump height. It is permissible to cut an inverted "U" in the polypropylene shroud to allow the passage of the tube through the shroud.
13. The pump wires must be routed to the unit wirebox, through the strain relief and attached to the terminal strip. Inside the wirebox cover is a wiring diagram (See Figure 2) which shows the attachment points.
14. Re-assemble all items and restore power. The condensate pump runs any time the compressor runs.

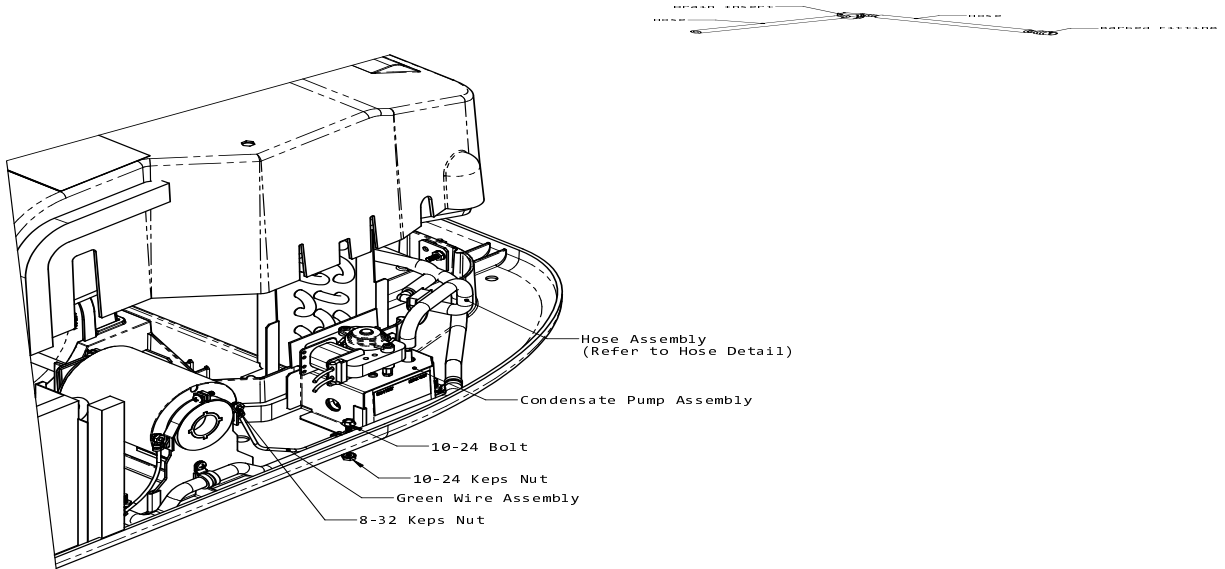

FIGURE 1

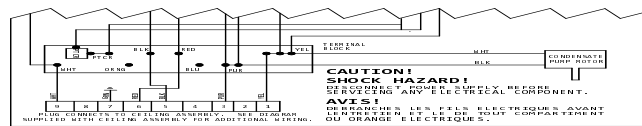

FIGURE 2