



INSTALLATION INSTRUCTIONS

FOR

9330B6151

ELECTRIC HEAT CONVERSION KIT

IMPORTANT NOTICE

These instructions are for the use of qualified individuals specially trained and experienced in installation of this type equipment and related system components.

Installation and service personnel are required by some states to be licensed. PERSONS NOT QUALIFIED SHALL NOT INSTALL NOR SERVICE THIS EQUIPMENT.

WARNING

Improper installation may damage equipment, can create a hazard and will void the warranty.

The use of components not tested in combination with these units will void the warranty, may make the equipment in violation of state codes, may create a hazard and may ruin the equipment.

WARNING - SHOCK HAZARD

To prevent the possibility of severe personal injury or equipment damage due to electrical shock, always be sure the electrical power source to the appliance is disconnected.

CAREFULLY FOLLOW ALL INSTRUCTIONS AND WARNINGS IN THIS BOOKLET TO AVOID DAMAGE TO THE EQUIPMENT, PERSONAL INJURY OR FIRE.

APPLICATION

This heater conversion kit (9330B6151) is designed for field application on the 9330-713 or 9330-714 ceiling assembly.

NOTE

The optional heating assembly is intended to take the chill out of the indoor air when the air is a few degrees too cool for comfort. The heater is an effective "chill chaser". It is not a substitute for a furnace.

SPECIFICATIONS

BTUH Capacity	5,600
Full Load Amps	16.0
Running Watts	1,800
Electrical Rating	115V, 60HZ, 1 Phase
USE TIME DELAY FUSE MAX. 20 AMPS OR MAX CIRCUIT BREAKERS	
U.L. H.A.C.R. TYPE 20 AMPS CSA 20 AMPS	
SUPPLY WIRES – 12 AWG. MIN. USE "COPPER" CONDUCTORS ONLY	

PARTS LIST

1. Electric Heat Assembly (1)
2. Heater Wire Assembly (1)
3. Thermostat Control (1)
4. Thermostat Knob (1)
5. Selector Switch Knob (1)
6. Wiring Diagram (1)

INSTALLATION

DANGER - SHOCK HAZARD

MAKE SURE THAT THE POWER SUPPLY TO THE UNIT IS DISCONNECTED BEFORE PERFORMING ANY WORK ON THE UNIT TO AVOID THE POSSIBILITY OF SHOCK INJURY OR DAMAGE TO THE EQUIPMENT.

1. Disconnect all electrical supply to the air conditioner.
2. Remove the grille and filters from the bottom of the ceiling assembly by disengaging the 1/4 turn fasteners.
3. Remove the three (3) screws that secure the nylon duct collar to the air conditioner basepan and the four (4) screws that hold the ceiling assembly to the unit mounting frame (See Figure 1).

4. Replace the selector switch control knob located on the right control box with the heat/cool control knob provided in the kit.
5. Remove the temperature control knob then remove the thermostat from the left control box and replace them with the thermostat and temperature control knob provided in the kit. Note that the thermostat capillary tube must route through a hole and into the filter area. When forming to shape, take care not to kink the capillary tube (See Figure 2).
6. Snap fit the heater wiring assembly into the rectangular opening inside the thermostat control box (See Figure 2).
7. Connect the wiring as follows:
 - A. Connect the two white wires removed from the thermostat to terminal 2 on the thermostat.
 - B. Connect the yellow wire removed from the thermostat to terminal 3 on the thermostat.
 - C. Connect the blue heater plug wire to terminal 1 on the thermostat.
 - D. Connect the orange heater plug wire to terminal 3 on the selector switch. This wire will need to lay in the wireway formed in the ceiling assembly chute. Electrical tape may be used over these wires to keep them in place.
8. Position the heater assembly in the air conditioner return air opening as shown in Figure 3. The heater bracket must be installed over the metal basepan extrusion and positioned between the basepan and the plastic drain pan (See Figure 4). Tighten set screw to secure the assembly so as to prevent movement.
9. Plug the heater assembly cord into the 2 position heater wire assembly (See Figure 2).

TIE ALL WIRING TO INSURE NO CONTACT WITH THE HEATER OR ANY SHARP EDGES. KEEP IN MIND THAT HIGH VELOCITY AIR WILL BE ENCOUNTERED IN THIS AREA.
10. Place the metal control box shield over the thermostat, switch and field wiring boxes. Make certain that all wires are pushed into the control boxes or laying in the wireway between the thermostat and switch boxes and will not be pinched by the control box shield. Control box shield is properly installed when the two holes in the shield are aligned with the two screw holes in the ceiling assembly chute (See Figure 2).
11. Raise the ceiling assembly and secure to the mounting frame with four (4) screws.
12. Secure the nylon duct collar to the air conditioner basepan with three (3) screws.
13. Apply the new wiring diagram over the existing diagram inside the ceiling assembly chute.
14. Position the ceiling grille and filters on the bottom of the shroud and engage the two 1/4 turn fasteners.
15. Turn the selector switch to OFF.
16. Restore electrical power to the air conditioner. Test all switch positions.

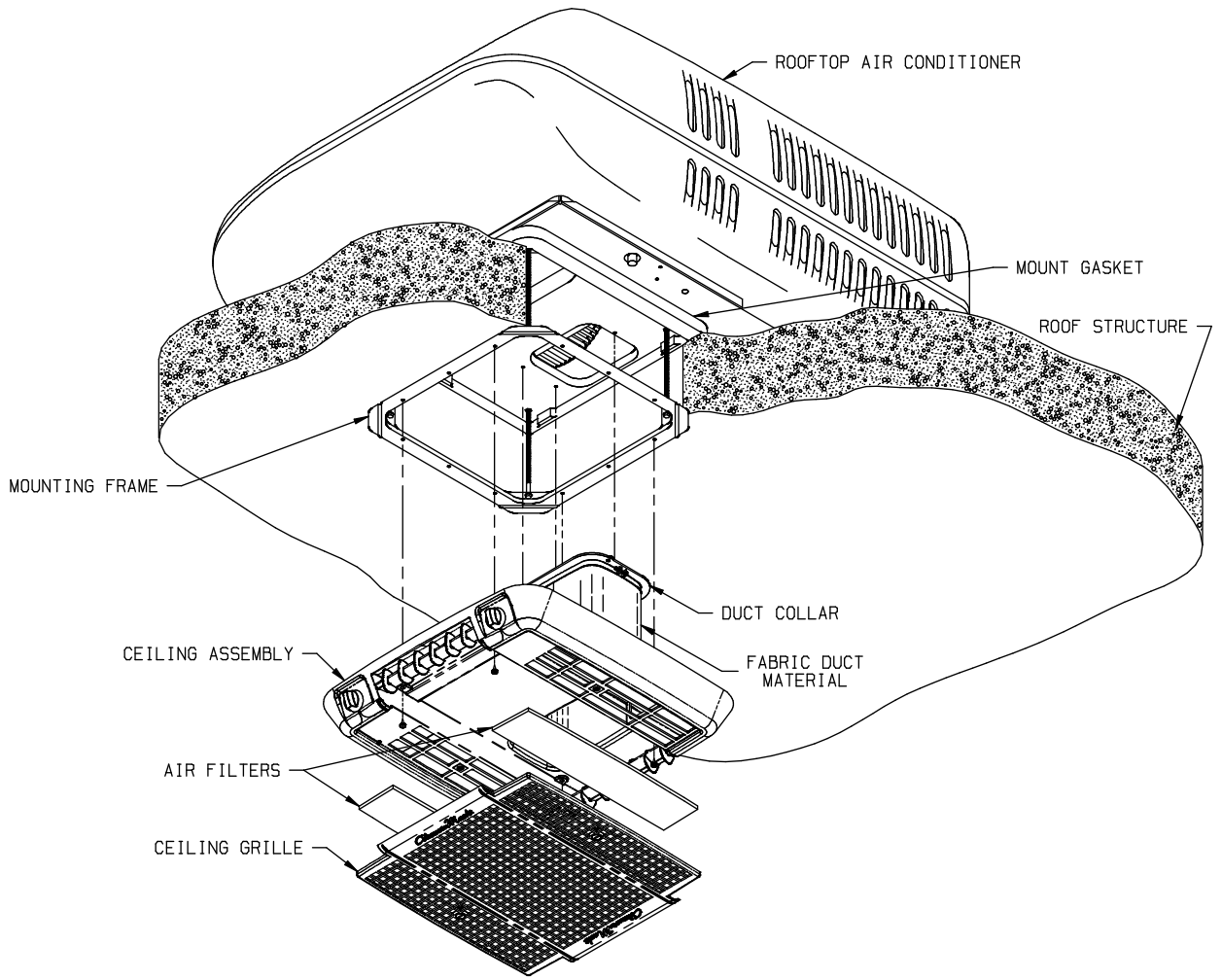

FIGURE 1

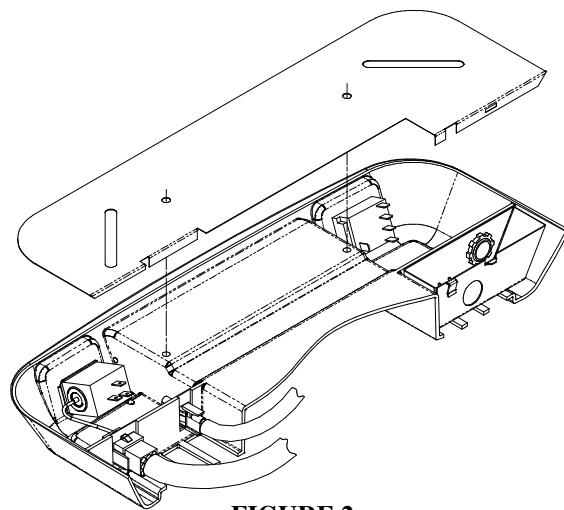

FIGURE 2

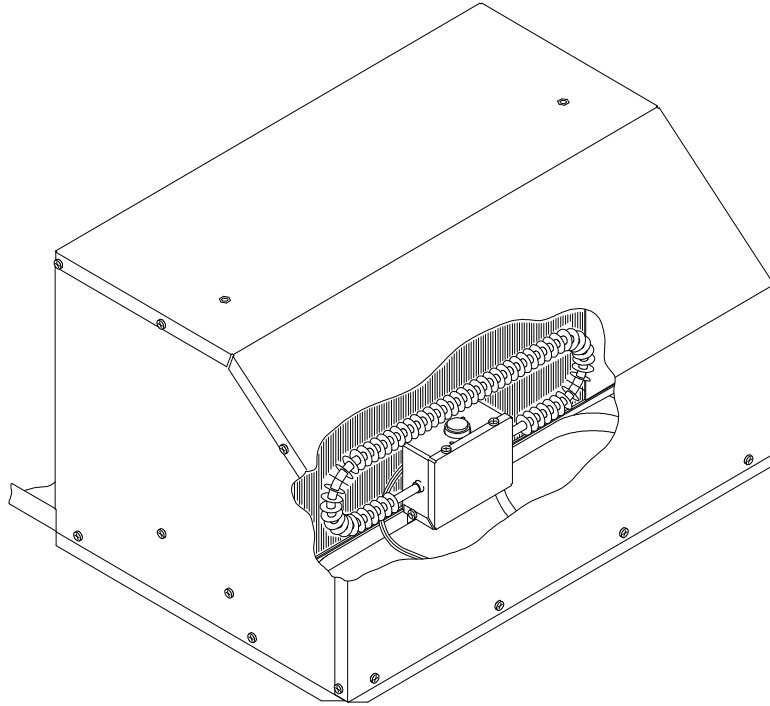

FIGURE 3

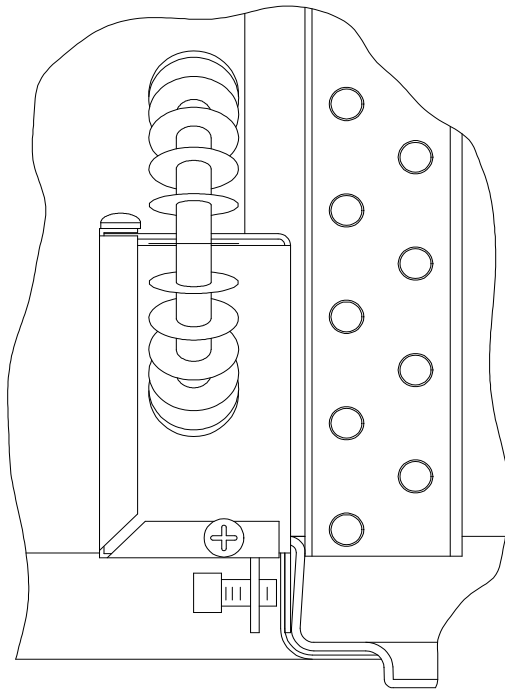

FIGURE 4



**Airxcel, Inc.
RV Products Division
P.O. Box 4020
Wichita, KS 67204**

1976C353 (12-10) PP

